

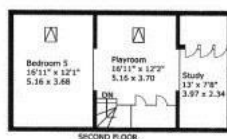

Howard Morley
& Sons

PER MONTH

£6,950 Per Month
Norley Lane



Approximate gross internal area:
House: 275 sq m / 2960 sq ft
Office: 14 sq m / 150 sq ft
TOTAL: 289 sq m / 3110 sq ft

This drawing is in accordance with
PAS 98 guidelines. It is not to scale and
is for illustration purposes only 2013

5



4



3



Energy Efficiency Rating

	Current	Potential
Very energy efficient - lower running costs		
(92 plus) A		
(81-91) B		
(69-80) C		
(55-68) D		
(39-54) E		
(21-38) F		
(1-20) G		
Not energy efficient - higher running costs		
England & Wales	EU Directive 2002/91/EC	



Agents Note: Whilst every care has been taken to prepare these particulars, they are for guidance purposes only. All measurements are approximate and are for general guidance purposes only and whilst every care has been taken to ensure their accuracy, they should not be relied upon and potential buyers/tenants are advised to recheck the measurements

Howard Morley
& Sons

OFFICE ADDRESS
276 High Street
Guildford
Surrey
GU1 3JL

OFFICE DETAILS
01483 575 304
lettings@hmorley.co.uk
hmorley.co.uk